

# 2026 Revised Master Plan/Schematic Design

St. Peter Catholic Church  
**Revised Schematic Design**  
 Parish Center Addition  
 (with Lower-Level Chapel  
 & Link from Church)  
 1/15/26



Floor Area Summary:	
<b>Basement:</b>	
Renovation:	2,110 s.f.
Addition:	9,150 s.f.
<b>First Floor:</b>	
Renovation:	2,110 s.f.
Addition:	10,168 s.f.
<b>Second Floor:</b>	
Renovation:	2,110 s.f.
Addition:	9,150 s.f.
<b>Subtotal:</b>	
Renovation:	6,330 s.f.
Addition:	28,468 s.f.
<b>TOTAL:</b>	<b>34,798 s.f.</b>

## SITE PLAN

1/15/2026

## ST. PETER CATHOLIC PARISH

27551 Volo Village Road, Volo, Illinois 60073  
© Jaeger Nickola Kuhlman & Associates, LTD. 2026



# 2026 Revised Master Plan/Schematic Design

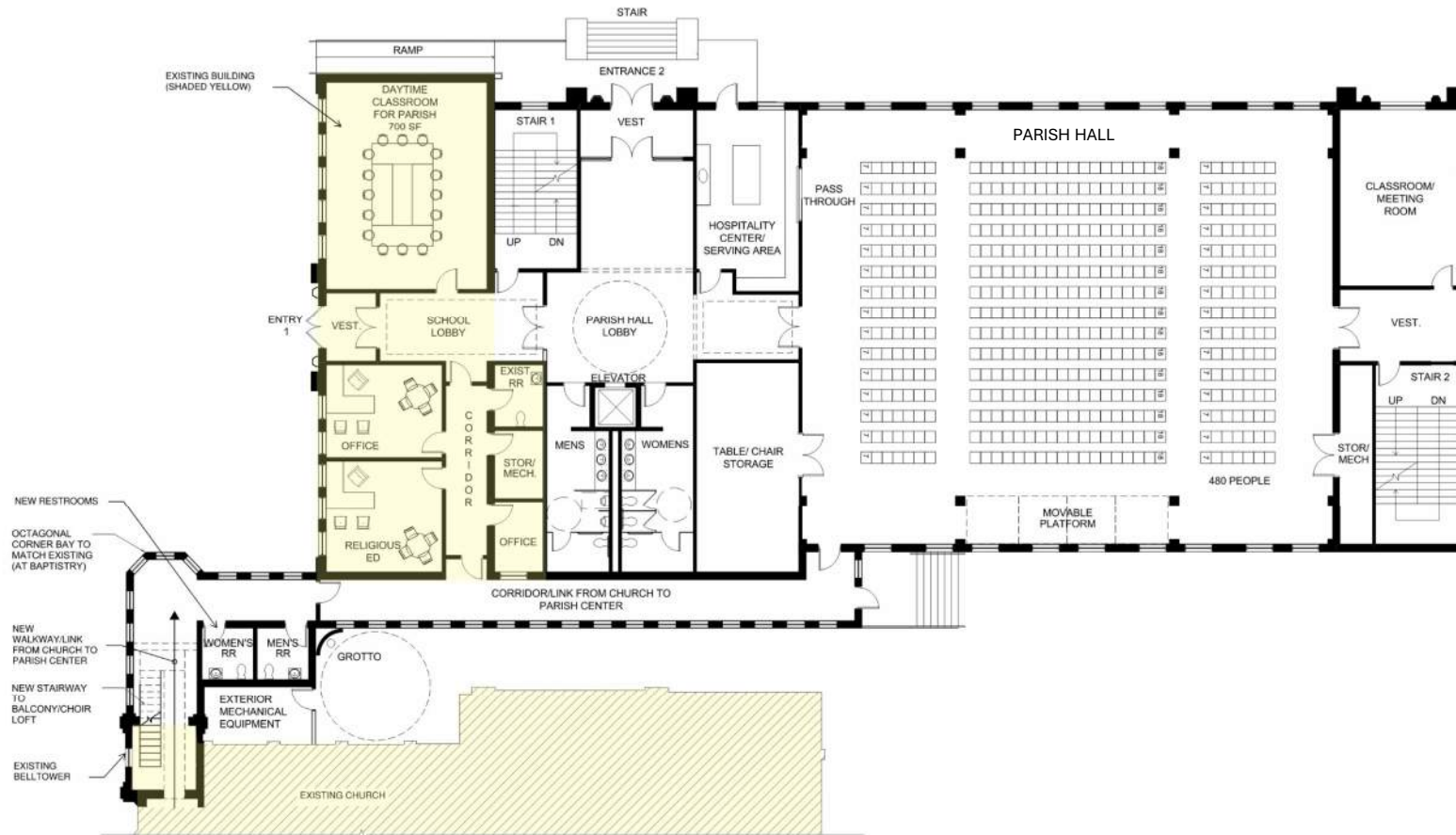

# 2026 Revised Master Plan/Schematic Design

